

Installation Instructions

Components

- | | |
|------------------|-------------------------|
| 1. Base Assembly | 5. Cover |
| 2. Seat Assembly | 6. M8 Lock Washer (x5) |
| 3. Back Assembly | 7. M8 Washer (x5) |
| 4. Gas Cylinder | 8. M8 x 20mm Screw (x5) |

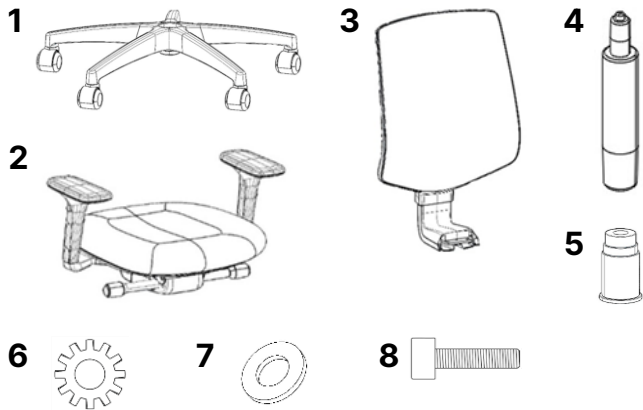

Tools Included



M8 Allen Key

M6 Allen Key

(Not used for product assembly recommended to periodically tighten screws.)

Step 1

Insert gas cylinder into center hole of base assembly.

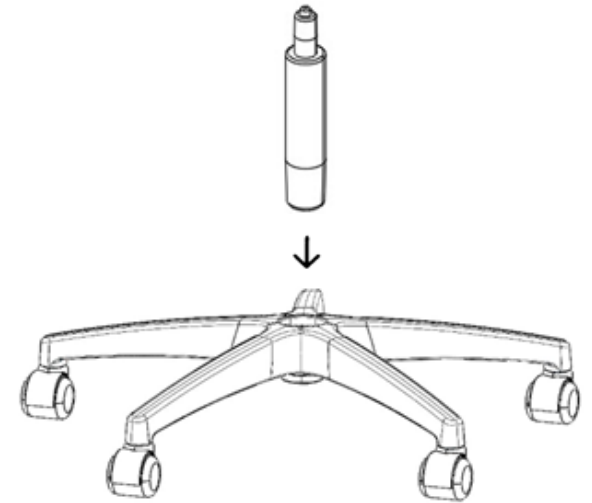

Step 2

Place cover on top of gas cylinder.

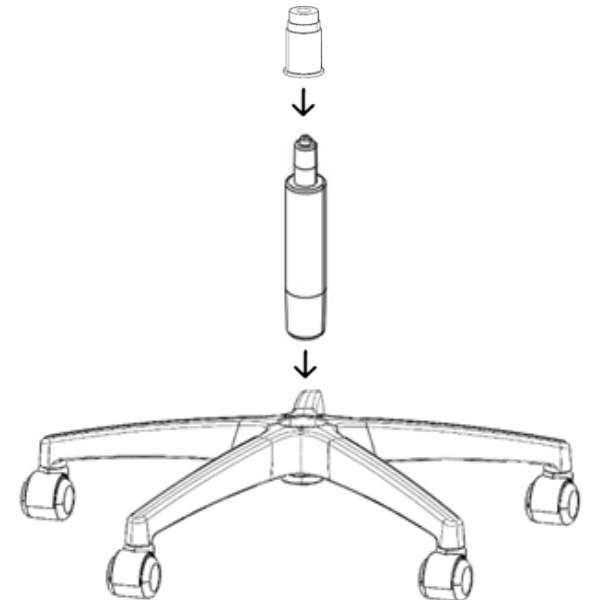

Installation Instructions

Step 3

Put one lock washer and one washer on each bolt.

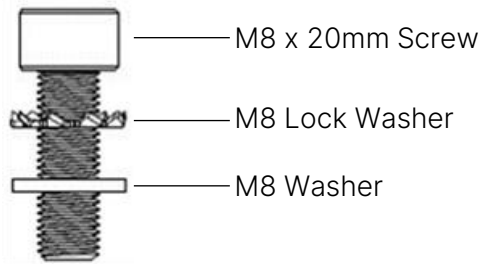

Step 4

Using the M8 Allen key provided, attach back assembly to seat assembly by aligning threaded holes in the "J" bar with slots in the mechanism. See Image.

Insert bolts into 5 places shown. Do not fully tighten bolts until all bolts are in place.

Note: "J" bar cover is not shown in graphic. Pull back cover to install screws.

Install screws and washers into 5 slots.

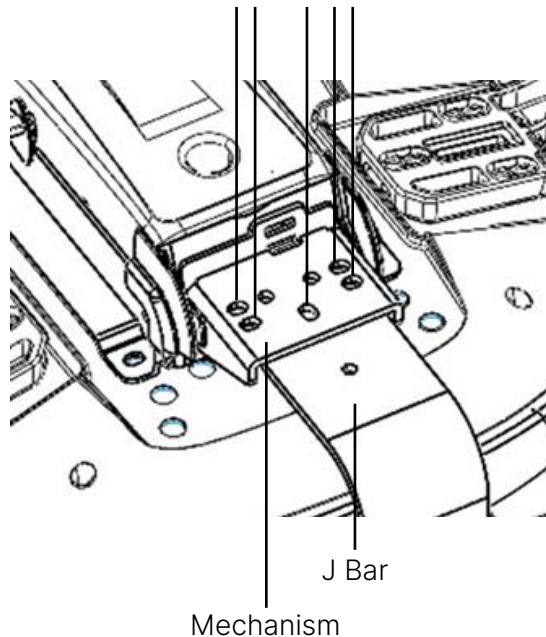

Step 5

Lower seat and back assembly onto gas cylinder.

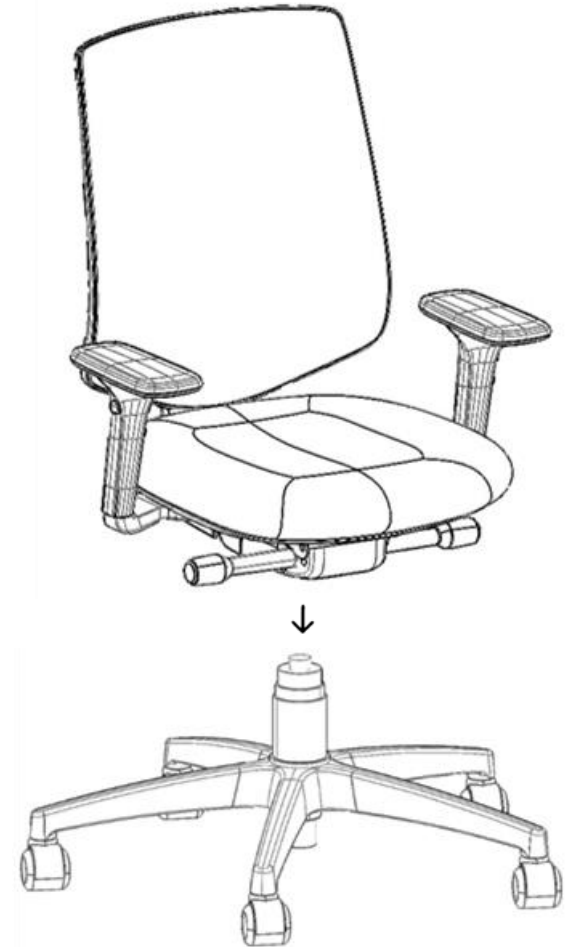

Chair Adjustments

Front

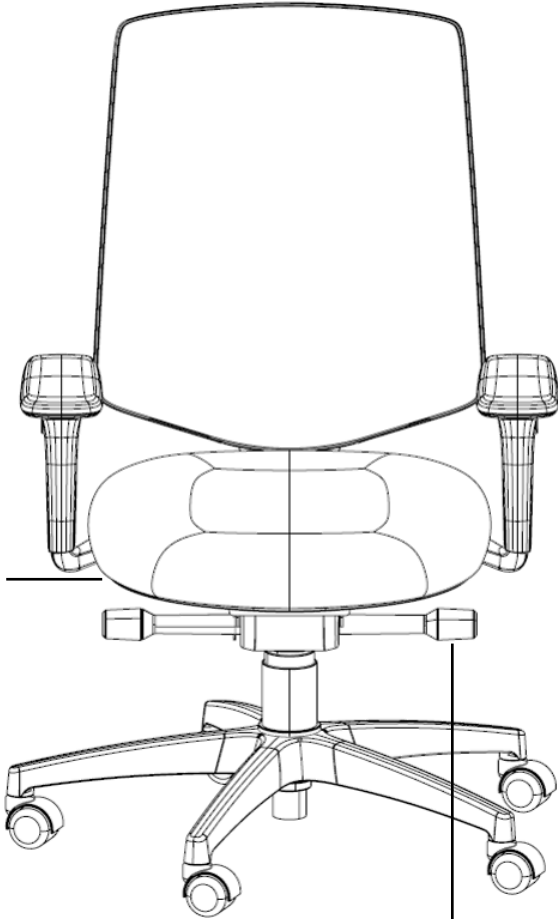

Seat Pan
Depth
(Slider)

Tilt Lock
(Twist)

Back

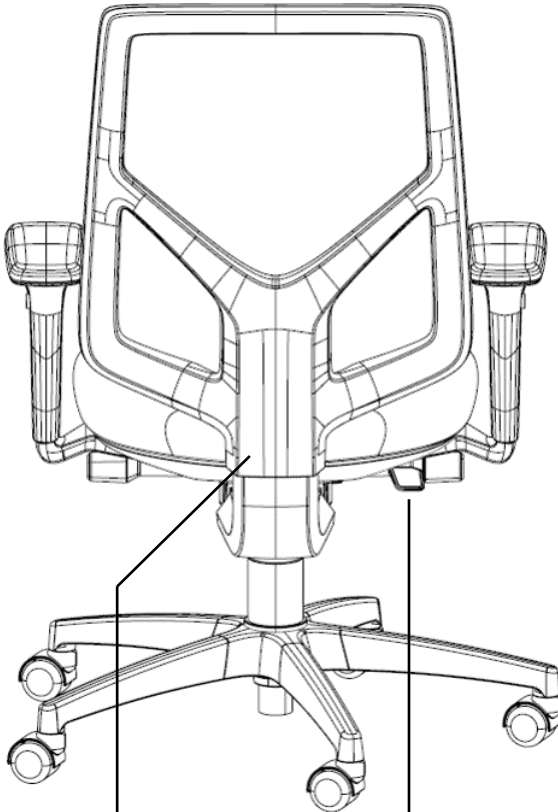

Back Height Adjust
(Pull up; Push down)

Seat Height Adjust Lever